



SOLAR MARINE LANTERN

Basic model

- DWS301: 6LEDs,
Steady on
- DWS302: 16LEDs,
Flashing At 40times/min
- DWS303: 16LEDs,
Flashing Codes

Marine Applications

1. Marine floating signs; waterfront safety lighting;
2. Mooring and researching buoys; small safety buoys
3. Private docks, boat houses swim rafts and so on
4. Sea ports warning
5. Aquaculture, i.e Aquafarm, fishery
6. Navigation for ships with 256 Flashing Codes

Airfield Applications

1. Runways lighting; Taxiways lighting
2. Runways edge lighting
3. Helipad edge lighting
4. Threshold lighting

Marker Applications

1. Barricade markers
2. Security markers
3. Flag markers
4. Emergency and portable lighting

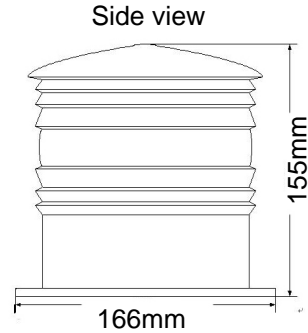
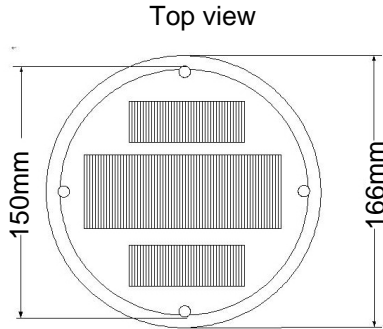

- Proprietary, patented dome design keeps birds, dust off, 4CM spikes on top is optional
- Uses high-intensity LEDs
No bulbs replacement
- Polycarbonate lens is virtually indestructible
- Ni-Mh batteries
Can be interchangeable after 4 years
- Installs in minutes using 4 bolts or screws
- Frangible base

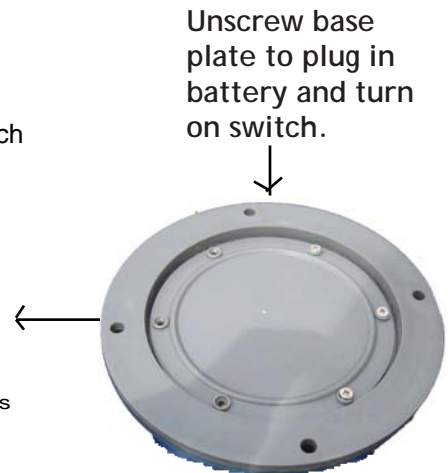
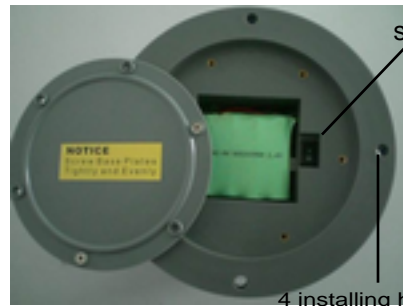

Unscrew base plate to plug in battery and turn on switch.

ISO 9001:2000



SOLAR MARINE LANTERN

Features & Benefits

1. Available in blue, red, amber, white and green.
2. Can be ordered in steady-on or flash patterns
3. Automatically turns on at dusk and off at dawn
4. Completely self-contained and watertight. Designed to operate reliably in harshest of environmental and work conditions.
5. Polycarbonate lens is virtually indestructible
6. Will charge under nearly all weather conditions and up to 140 hours of operating capacity from a full charge.
7. Manufactured to ISO9001:2000 Quality Assurance standards.
8. Proprietary, patented dome protects solar panel while improving efficiency, sheds snow.
9. Installation takes minutes and requires minimal technical expertise

SPECIFICATIONS

LIGHT OUTPUT	DWS302	FLASHING	STEADY ON	DWS301
Effective Intensity				
Green		10.4~12.0 candela		6.5~7.5 candela
Blue		5.4~7.2 candela		3.0~4.0 candela
Amber and white		12.0~16.0 candela		7.5~10.0 candela
Red		8.0~12.0 candela		5.0~7.5 candela

Nominal Night Range +5.5km 3.6km
 Vertical Divergence ±3.5° at 50% intensity
 Horizontal Output 360°

Operation
 Minimum Autonomy 140Hours 60Hours
 Latitude Range 55°S to 55°N
 On/Off Level 60/100 Lux
 Lifespan of LEDES up to 100,000 Hours

Solar panels
 Type poly-crystalline
 Potted with UV-protected Polyurethane and doomed for higher efficiency
 Maximum Power 1.1 watts
 Efficiency 15%

Battery
 Type Nickel-Hydrogen replaceable
 Capacity 5.0Ah
 Construction
 Lens Material Polycarbonate
 Sealing Self-contained unit, potted with polyurethane
 Weight 0.9kg

Environmental and Electrical
 Temperature Range - 40 C to +60 C
 Waterproof as per IP67

Quality control and Patents
 Quality Assurance ISO9001:2000
 CE Report No: CTR090817073E

Patents Chinese patents: 02224444.1 and 200430015589.3
 Other patents pending

*ALL THE SPECIFICATIONS ARE ROUGH AND SUBJECT TO CHANGE WITHOUT NOTICE



marine lantern

buoy lantern

